

STILO VERSO CS 2P

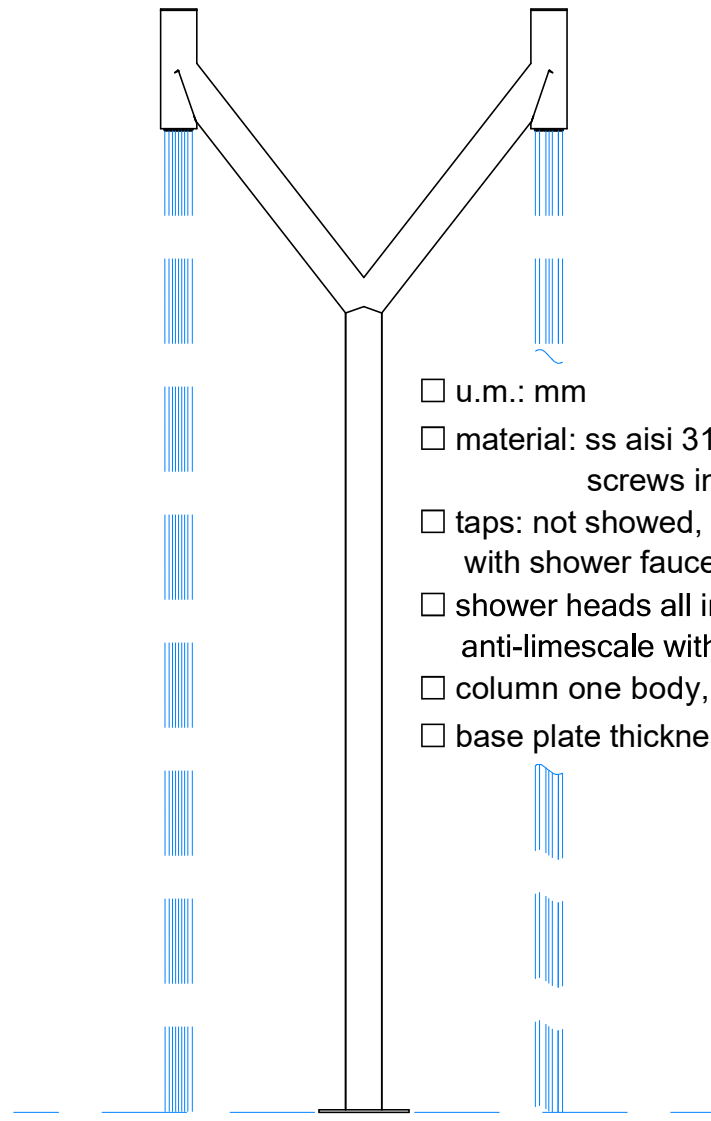

- u.m.: mm
- material: ss aisi 316L,
screws in aisi 316 (A4)
- taps: not showed, see technical sheet
with shower faucets arrangement
- shower heads all in ss 316L, inspectables,
anti-limescale with buses in neutral silicone
- column one body, thickness: 2mm
- base plate thickness: 5mm

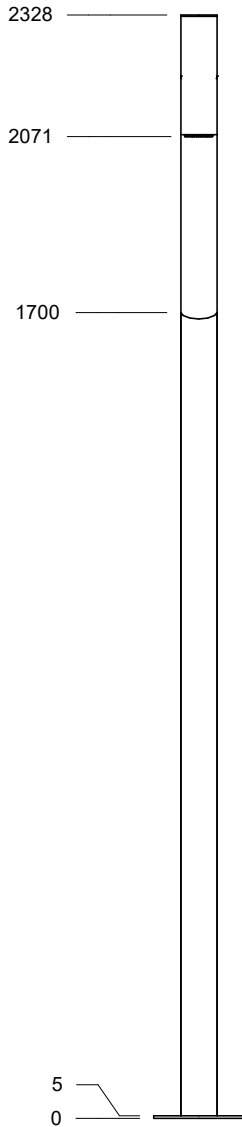
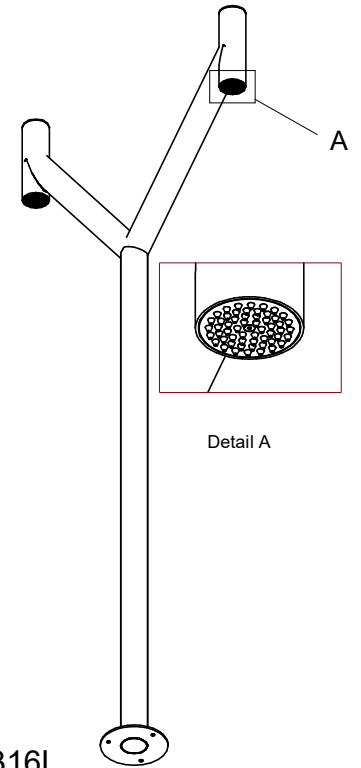
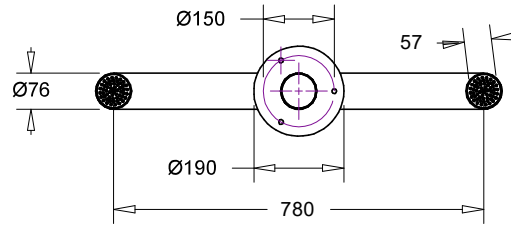